



## Mounting aid MH-EXG-30

- Clamp for threaded pipe
- Suitable for all M30 sensors, including reduction factor 1
- Simple and quick exchange without readjustment
- 2 panel nuts included
- Free of paint wetting interfering substances
- Significantly reduced influence on the switching distance

Quick mounting bracket with dead stop

### Dimensions

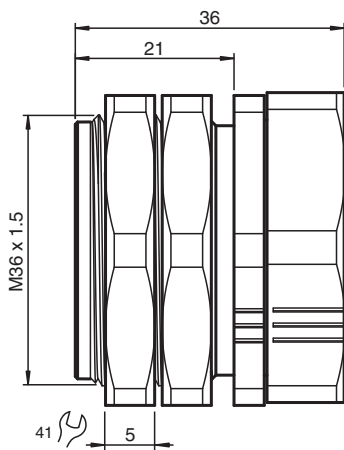

### Technical Data

|                                  |   |  |
|----------------------------------|---|--|
| <b>Ambient conditions</b>        |   |  |
| Ambient temperature              |   | -40 ... 90 °C (-40 ... 194 °F)   |
| <b>Mechanical specifications</b> |   |  |
| Length                           | L | 36 mm<br>thread length of sensor min. 34 mm  |
| Diameter                         |   | sensor min. 29.73 mm<br>sensor max. 30 mm  |
| Material                         |   | brass, nickel-plated<br>free of paint wetting interfering substances                     |
| Screwed connection               |   | SW = 41 mm   |
| Dimensions                       |   | M36 x 1.5 external thread  |
| Tightening torque                |   | 36 Nm  |
| <b>General information</b>       |   |  |
| Note                             |   | Attention: Sensor shape dependent, it will be fixed up to 0.7 mm in back-flush position. |

Release date: 2022-12-19 Date of issue: 2022-12-19 Filename: 70112559\_eng.pdf

Refer to "General Notes Relating to Pepperl+Fuchs Product Information".

Pepperl+Fuchs Group  
www.pepperl-fuchs.com

USA: +1 330 486 0001  
fa-info@us.pepperl-fuchs.com

Germany: +49 621 776 1111  
fa-info@de.pepperl-fuchs.com

Singapore: +65 6779 9091  
fa-info@sg.pepperl-fuchs.com

**PF** PEPPERL+FUCHS

Mounting

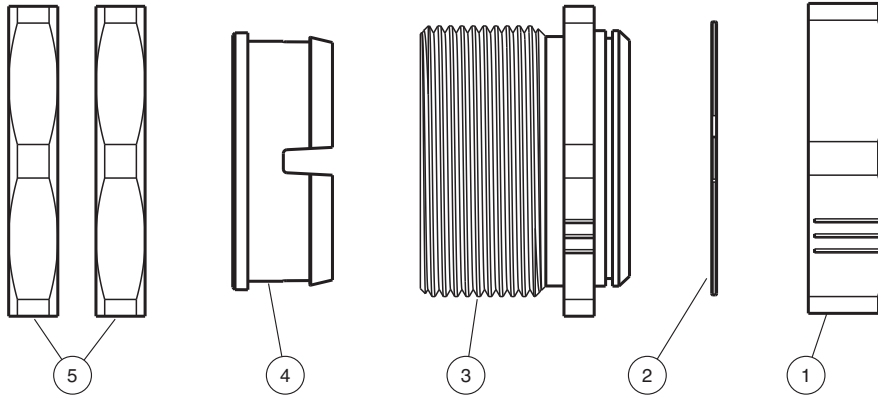

Release date: 2022-12-19 Date of issue: 2022-12-19 Filename: 70112559\_eng.pdf

Refer to "General Notes Relating to Pepperl+Fuchs Product Information".

Pepperl+Fuchs Group  
www.pepperl-fuchs.com

USA: +1 330 486 0001  
fa-info@us.pepperl-fuchs.com

Germany: +49 621 776 1111  
fa-info@de.pepperl-fuchs.com

Singapore: +65 6779 9091  
fa-info@sg.pepperl-fuchs.com